

ZONING
DISTRICT
MAP

ZONING DISTRICTS

- (A) AGRICULTURE
- (H) HAMLET RESIDENTIAL
- (CR1) LOW DENSITY COUNTRY RESIDENTIAL
- (CR2) MEDIUM DENSITY COUNTRY RESIDENTIAL
- (CR3) HIGH DENSITY COUNTRY RESIDENTIAL
- (CR4) PREMIUM DENSITY COUNTRY RESIDENTIAL
- (RMH) MOBILE HOME RESIDENTIAL
- (C1) GENERAL COMMERCIAL
- (C2) HIGHWAY COMMERCIAL
- (M) INDUSTRIAL
- (CON1) CONSERVATION & ACTIVE RECREATION
- (CON2) CONSERVATION & PASSIVE RECREATION

• This is the Zoning District Map which accompanies Bylaw Number _____ adopted by the Rural Municipality of Prince Albert No. 461.

Reeve _____

Rural Administrator _____

• Approved on the _____ day of _____

Minister
Saskatchewan Municipal Affairs

CROSBY HANNA & ASSOCIATES  407 1st Ave. North
Saskatoon SK S7K 1X
www.crosbyhanna.ca

LANDSCAPE ARCHITECTURE T (306) 665-344
COMMUNITY PLANNING F (306) 652-961

Sheet No.  DATE 09/10/13
2 of 7 PROJECT NO. CHA 07062

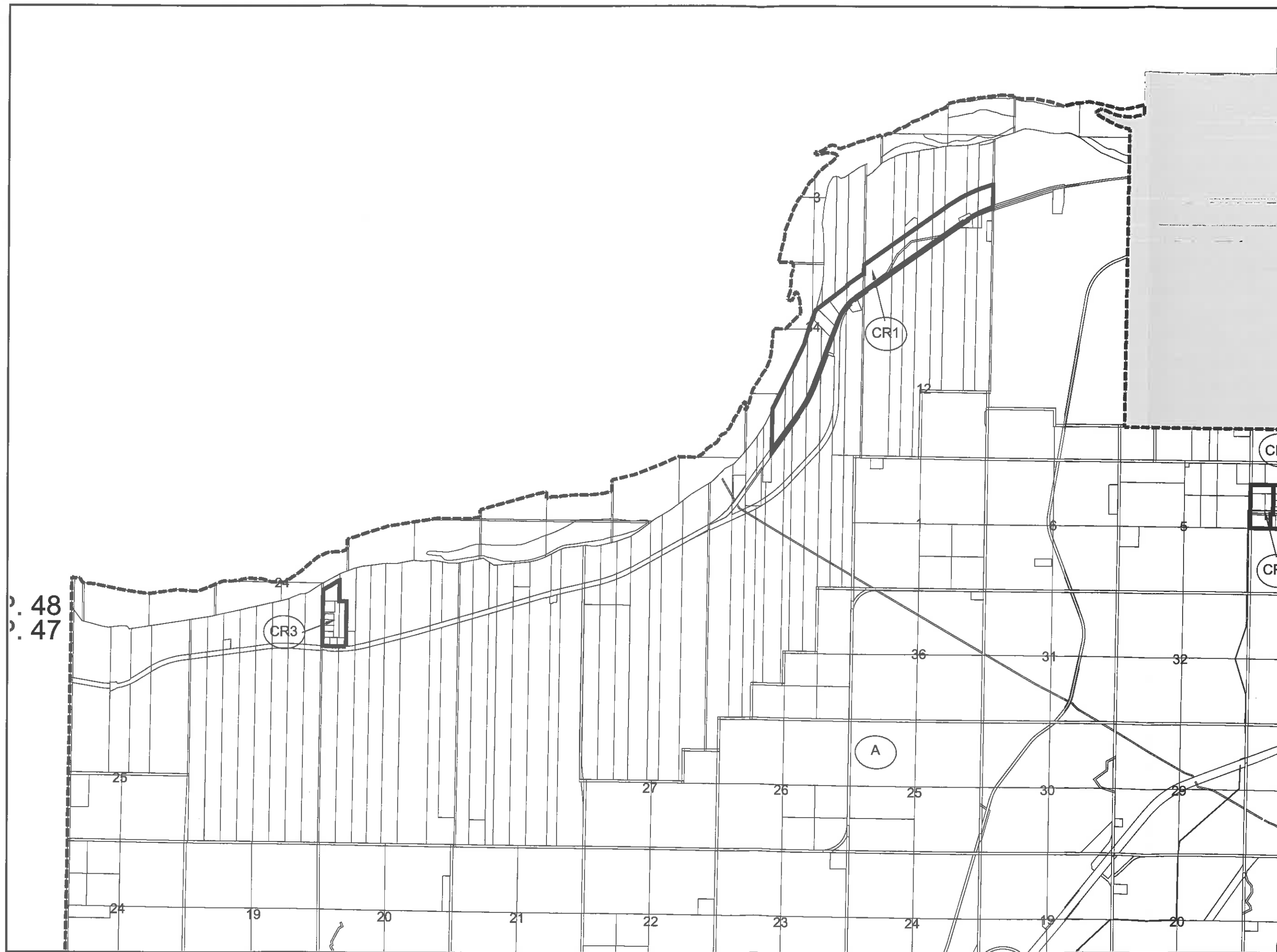

P. 48
P. 47